

VELUX Skylight installed in new metal roofing.

1. The sheets are fitted 100 mm from the bottom frame
2. The flashing is mounted
3. Fit the metal sheets

BASIS OF DESIGN:
VELUX Venting
Skylight (VS, VSE)

VELUX Skylight installed in to existing metal roofing. **ELEVATIONS**

1. The metal sheet is cut to allow for the flashing apron.
The cut must stop on top of a profile
(min 270 mm from the side frame)
2. The filler piece is placed so it fits the cut
(can be fixed to the existing metal sheets with rivets)
(Shape the filler piece from the cut-out sheets of
the skylight)

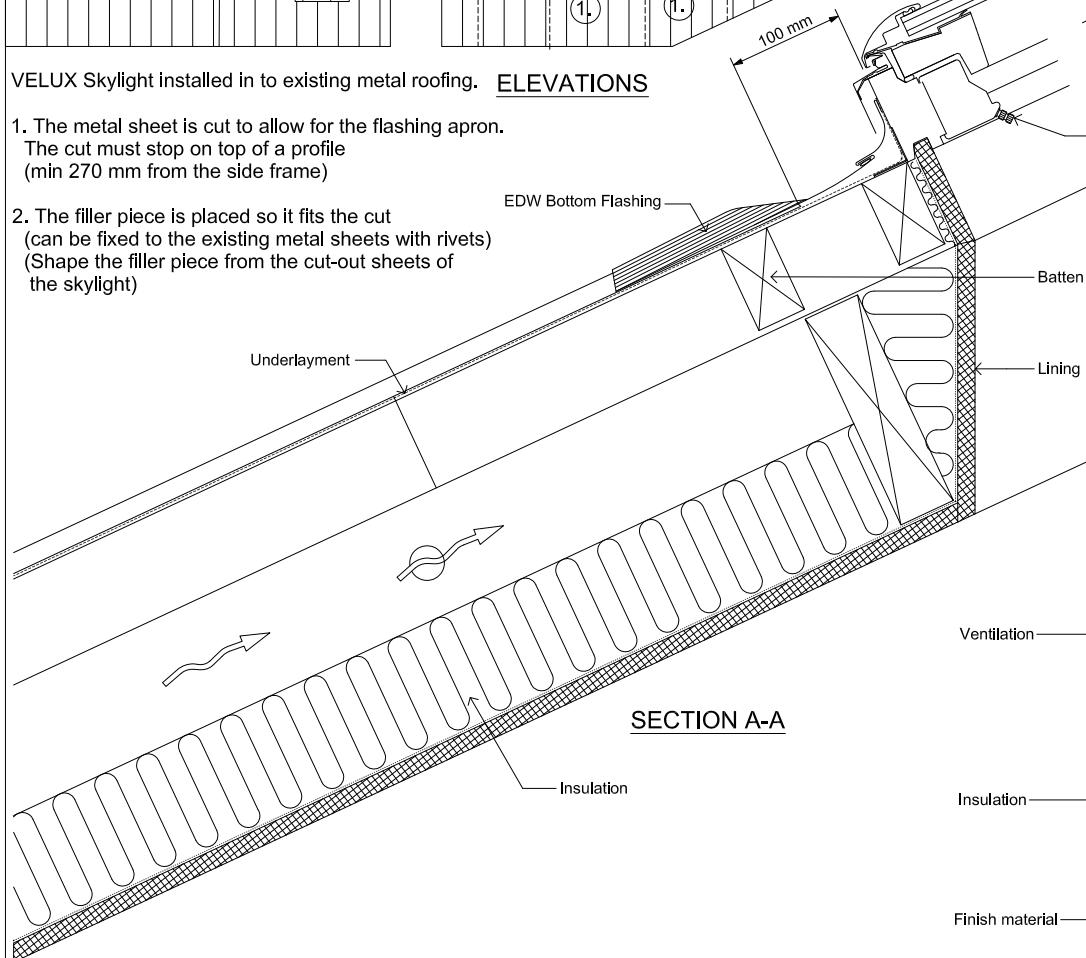

SECTION A-A

Ventilation

Insulation

Finish material

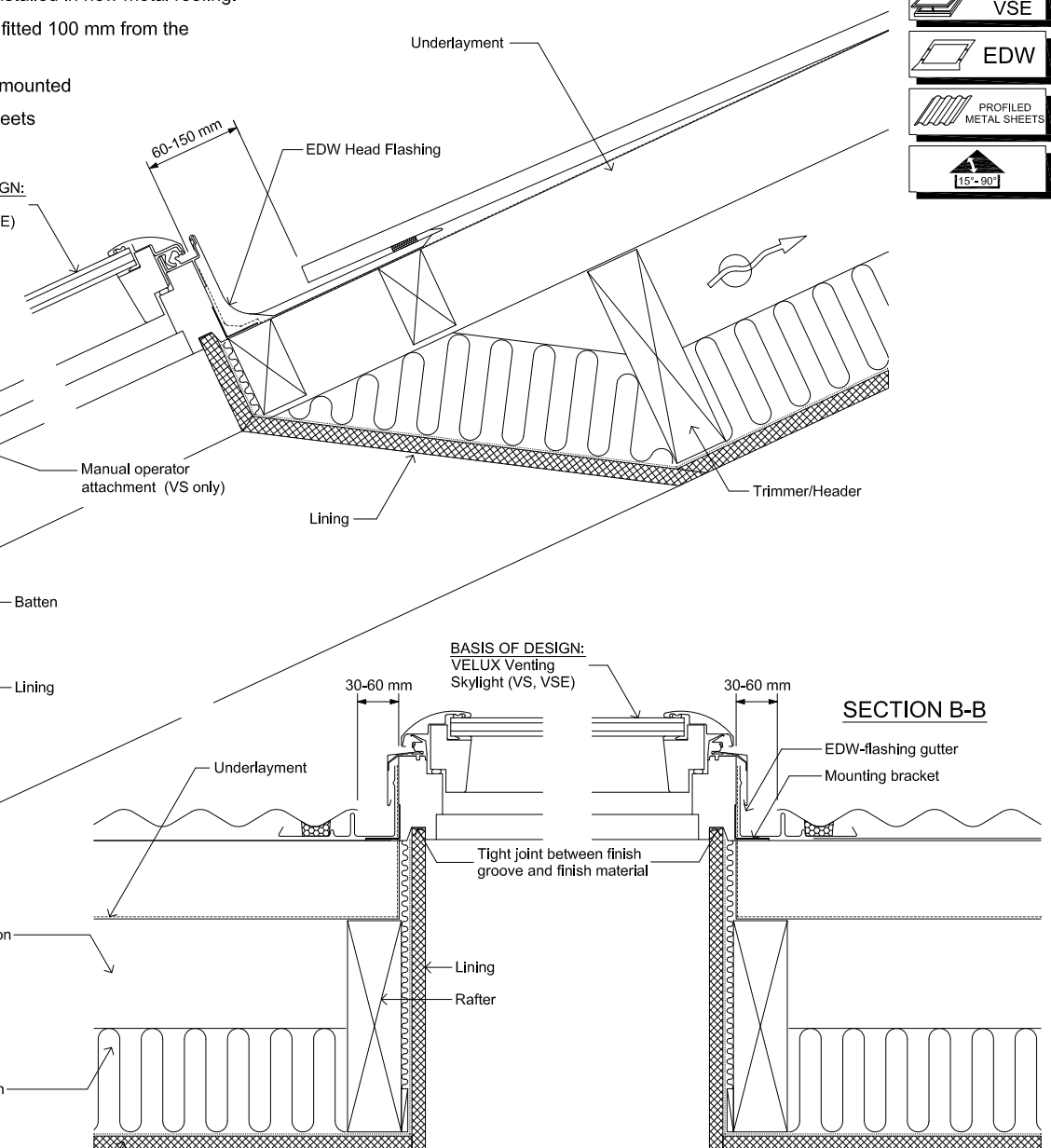

SECTION B-B

BASIS OF DESIGN:
VELUX Venting
Skylight (VS, VSE)

VELUX
Sky-Product Management

NEW ZEALAND LTD.
0800 650 445

VS, VSE - Venting Skylight and EDW Flashing in Profiled Metal Roof

Name	Date
Drawn by	June 11
Checked by	June 11
Drawing No.	